



CONTENT



TECHNICAL SPECIFICATIONS

DOWN LIGHT Round / Recessed	ATILA ROUND 18W
Power	18 W
Power supply	85/265V AC
CCT Colour	6500 Kv (Pure white)
Brightness	1400 Lumens
CHIP	SMD 2835
Opening angle	120 °
Useful life	30.000 Hours
Protection	IP 44
Dimensions	300x300x40 mm
Material	Aluminium white
Certificates	CE & RoHS
Included	Light and Driver
Rep Chromatic Index (CRI)	80
Efficiency	90%
Work environment	-22°C / 45°C
WARRANTY	2 Years

CAUTIONS:

Always shut off power to the circuit before starting installation work. In some countries electrical installation work may only be carried out by a authorised electrical contractor. Contact your local electricity authority for advice. Different materials require different types of fittings. Always choose screws and plugs that are specially suited to the material. The light source of this product is nonchangeable light diodes (LED). Do not disassemble the product, as the light diodes can cause damage to the eyes. Do not immerse in water. Cleaning: Use a damp cloth, never a strong cleaning agent.

Square surface downlight LED 18W/ 6500K - SMD2835 230V

Finish: WHITE - Ref.: 083581801 MOD: **SALADINO**

DOWNLIGHT Square SURFACE LED 18W SMD 2835
230V-AC. Measures: 300x300 mm x 40 mm. With an opening angle of 120° and white metal casing.

DESCRIPTION:

One of the main advantages of Downlights or lamps LED surface is that they are very easy to install since. Do not require holes. There is no UV or IR radiation, 0% mercury or hazardous materials, Favorable to the environment.

Low energy consumption, ideal for energy saving.

It does not generate virtually heat. No noticeable flicker

APPLICATION:

General indoor lighting

Ideal for replacing all types of recessed luminaires ceiling. Easy installation and maintenance free, ideal for Home, offices, shops, corridors, shops, bars, etc.

Steps for installation

- 1 Please connect colored wires.
DO NOT FORGET TO DISCONNECT THE MAIN SWITCH
- 2 Check and attach with the anchor plate bolts
- 3 Connect your LED Driver as shown (Fig 3)
- 4 Fasten your LED anchor by screws.

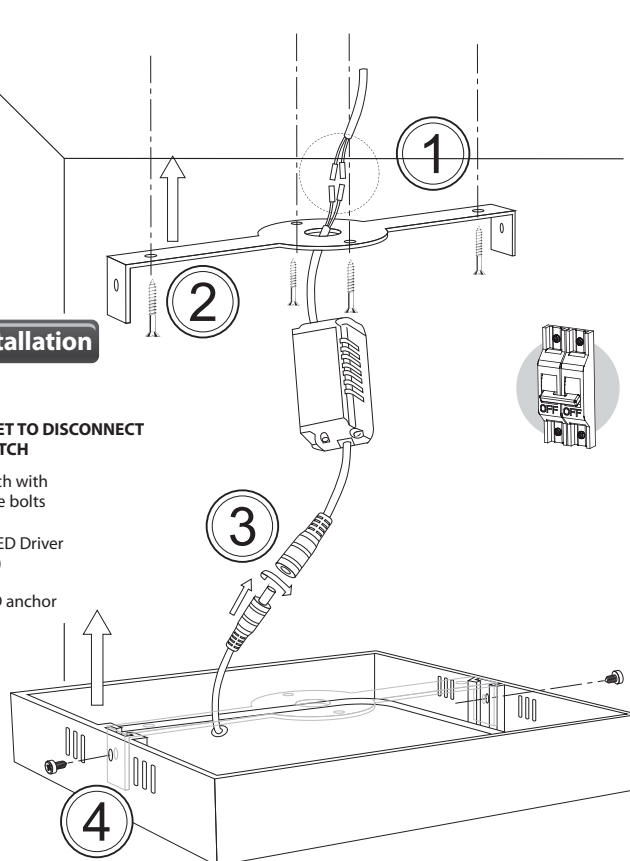

OTHER RELATED PRODUCTS:

Downlight LED AQUILES round/surface
Downlight LED PEGASO square/surface